

## VK-1037 Graphic Dimensions

Tension Fabric Backwall

QTY. 1

Please ADD 1" of bleed to all 4 sides

1/2" Hook Velcro to be sewn into all 4 FRONT sides.

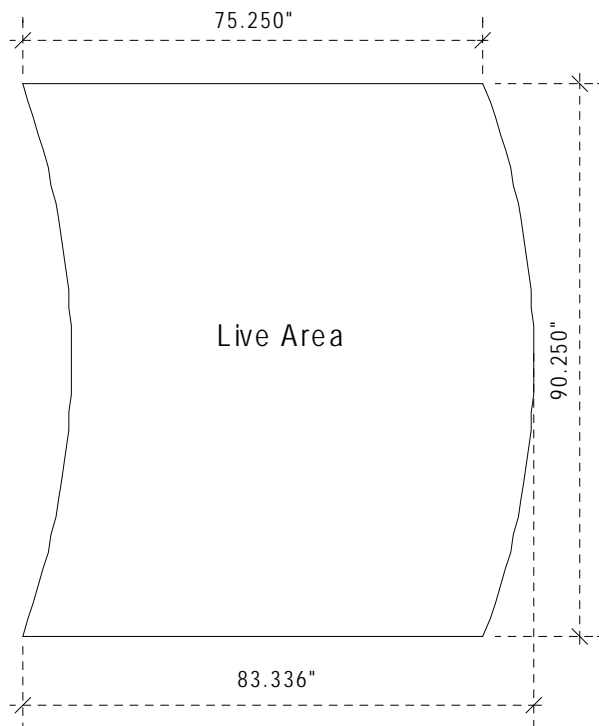

Circle Radius: 130.2281"

Tension Fabric Backwall

QTY. 1

Please ADD 1" of bleed to all 4 sides

1/2" Hook Velcro to be sewn into all 4 FRONT sides.

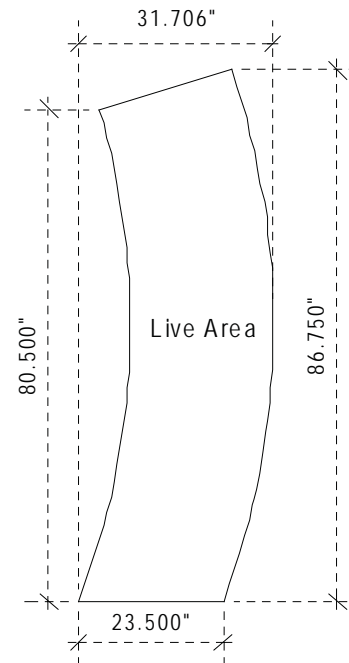

Tension Fabric Backwall

QTY. 1

Please ADD 1" of bleed to all 4 sides

1/2" Hook Velcro to be sewn into all 4 FRONT sides.

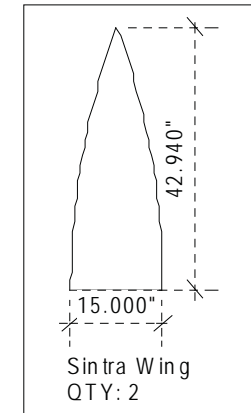
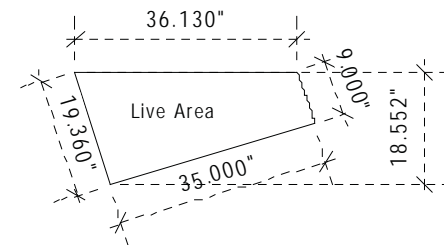

Sin tra Wing  
QTY: 2

**NOTE:** These dimensions are for graphic layout purposes. Graphic needs to be cut and test fitted to Magellen frame for exact sizes and cuts.